

CAR PARK BREAK DOWN	
H - Hotel	15
S - Shop	6
R - Residential	55
RV - Visitors	6
<b>TOTAL</b>	<b>82</b>

HOTEL BREAK DOWN	
Deluxe 1 Bedroom	12
Deluxe Studio	6
Studio	22
Deluxe Hotel Room	6
Hotel Room	39
<b>TOTAL</b>	<b>85</b>

APARTMENT BREAK DOWN	
2 Bedroom Dual Key	34
2 Bedroom	10
1 Bedroom	23
<b>TOTAL</b>	<b>67</b>

# DRAFT UNIT TITLE PLANS

DATE	REVISION	BY	CHK	NO.
26/03/2018	DRAFT UNIT TITLE PLANS			-
07/03/2019	DRAFT UNIT TITLE PLANS			A
07/05/2019	DRAFT UNIT TITLE PLANS			B
20/06/2019	DRAFT UNIT TITLE PLANS			C
09/07/2019	DRAFT UNIT TITLE PLANS			D

DATE	REVISION	BY	CHK	NO.

CONSULTANTS			
STRUCTURAL ENGINEER	<input type="checkbox"/> ENOVATE		T +64 9 320 3060
SURVEYOR	<input type="checkbox"/> HARRISON GRIERSON		T +64 9 917 5000
FIRE ENGINEER	<input type="checkbox"/> HOLMES FIRE		T +64 9 308 7030
	<input type="checkbox"/>		
	<input type="checkbox"/>		



**plus** architecture  
 Auckland Melbourne Brisbane  
 Christchurch Sydney  
 Telephone +64 9 261 3800  
 Suite 602, Level 06 Ironbank 150 Karangahape Road, Auckland, New Zealand  
 arch@plusarchitecture.co.nz #plusarchitecture

PROJECT	DRAWING TITLE
770 Great South Road Wiri Auckland 2104 New Zealand	SITE PLAN

SCALE	DATE	DRAWN	JOB NO.	DRAWING NO.	REVISION
1:200 @A1	9/07/2019		90107		D

In accepting and utilizing this document the recipient agrees that Plus Architecture New Zealand LP CN 2627994 retains all common law, statutory law and other rights including copyright and intellectual property rights. The recipient agrees not to use this document for any purposes other than its intended use, to waive all claims against Plus Architecture resulting from unauthorised changes, or to reuse the document on other projects without the prior written consent of Plus Architecture. Under no circumstances shall transfer of this document be deemed a sale. Plus Architecture makes no warranties of fitness for any purpose. The Builder/Contractor shall verify job dimensions to any work commencing. Figured dimensions shall take precedence over scaled work.

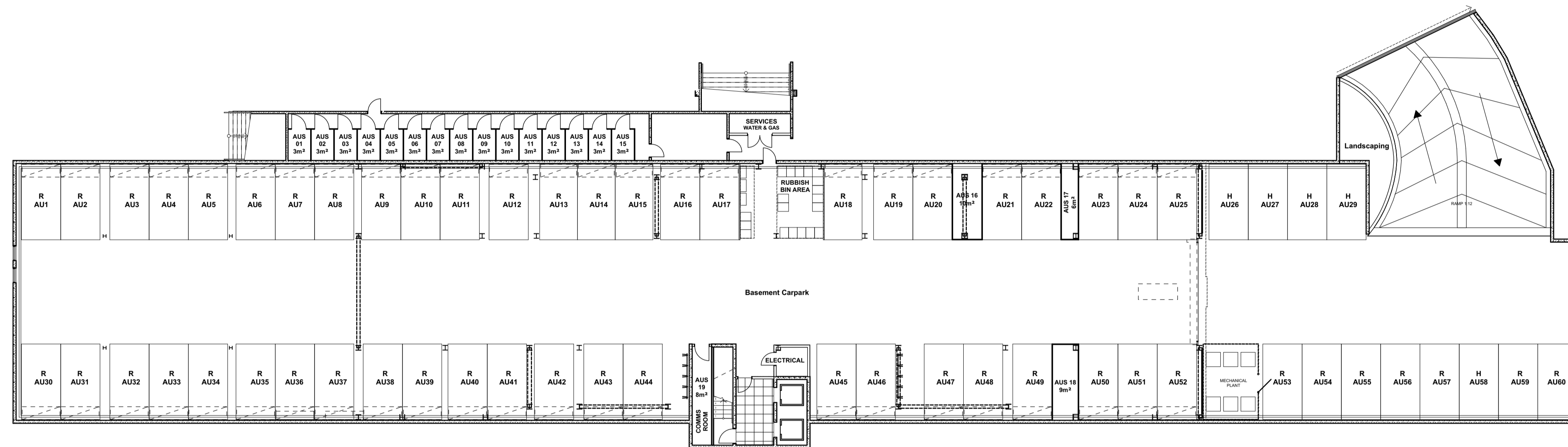

BASEMENT

CAR PARK BREAK DOWN	
H - Hotel	15
S - Shop	6
R - Residential	55
RV - Visitors	6
<b>TOTAL</b>	<b>82</b>

# DRAFT UNIT TITLE PLANS

DATE	REVISION	BY	CHK	NO.
26/03/2018	DRAFT UNIT TITLE PLANS			-
07/03/2019	DRAFT UNIT TITLE PLANS			A
07/05/2019	DRAFT UNIT TITLE PLANS			B
20/06/2019	DRAFT UNIT TITLE PLANS			C
30/07/2019	DRAFT UNIT TITLE PLANS			D

DATE	REVISION	BY	CHK	NO.

CONSULTANTS			
STRUCTURAL ENGINEER	<input type="checkbox"/>	ENOVATE	T +64 9 320 3060
SURVEYOR	<input type="checkbox"/>	HARRISON GRIERSON	T +64 9 917 5000
FIRE ENGINEER	<input type="checkbox"/>	HOLMES FIRE	T +64 9 308 7030
	<input type="checkbox"/>		
	<input type="checkbox"/>		



**plus** architecture

Auckland Melbourne Brisbane Christchurch Sydney

Suite 602, Level 06 Ironbank  
150 Karangahape Road, Auckland  
Phone +64 9 261 3800  
arch@plusarchitecture.co.nz  
www.plusarchitecture.co.nz

PROJECT	DRAWING TITLE	SCALE	DATE	PLOT DATE
770 Great South Road Wiri Auckland 2104 New Zealand	BASEMENT	1:200 @A1		9/07/2019
			DRAWN	CHECKED
			JOB NO.	DRAWING NO.
			<b>90107</b>	
			REVISION	
				<b>D</b>

In accepting and utilising this document the recipient agrees that Plus Architecture New Zealand LP CN 262794 retain all common law, statutory law and other rights including copyright and intellectual property rights. The recipient agrees not to use this document for any purposes other than its intended use, to waive all claims against Plus Architecture resulting from unauthorised changes, or to issue the document on other projects without the prior written consent of Plus Architecture. Under no circumstances shall transfer of this document be deemed a sale. Plus Architecture makes no warranties of fitness for any purpose. The Builder/Contractor shall verify job dimensions to any work commencing. Figured dimensions shall take precedence over scaled work.